

Species	Size	Spacing
<b>NATIVE SPECIMENT TREES:</b>		
Betula Pendula (Birch)	18-20cm girth	
Prunus Padus (Bird Cherry)	18-20cm girth	
Amelanchier lamarck ii	18-20cm girth	

- Type 1 - 3Bed, 5 Person 2 Storey Terraced - @ 99.8 sq.m. 10 Number
- Type 2 - 2Bed, 4 Person 2 Storey Terraced - @ 87.8 sq.m. 6 Number
- Type 3 - 1Bed, 2 Person Apartment - 6 Number  
 1 @ 46.3 sq.m.  
 4 @ 48 sq.m.  
 1 @ 50.1 sq.m.

**Parking:**  
 Shared Parking - 45 No  
 Disabled Parking - 5 No.  
 Total - 50 No. Spaces

**Site Area:** 0.736 Ha  
**Public Open Space :** 0.092HA - 12.5%  
**Density :** 29.8 Per HA

**Road Width - 6m**  
**Footpath Width - 2m**  
**Combined Cycle Lane/Footpath - 3m**  
**Minimum Private Open Space - Houses 60 sq.m.**

Refer to Site Services Drawings for Services Details

**Boundary Legend**

Boundary Description	Key Reference
0.8m High Plastered and Capped Wall with 1.8m Piers at 2m centres with 0.7mm metal railing between same	A
2m High Plastered and Capped Blockwork Walls (Reduce Heights as noted on plans)	B
2m High Concrete Post and Concrete Panel Fence to Existing Boundary Ditch	C
2m High Concrete Post and Concrete Panel Fence	D

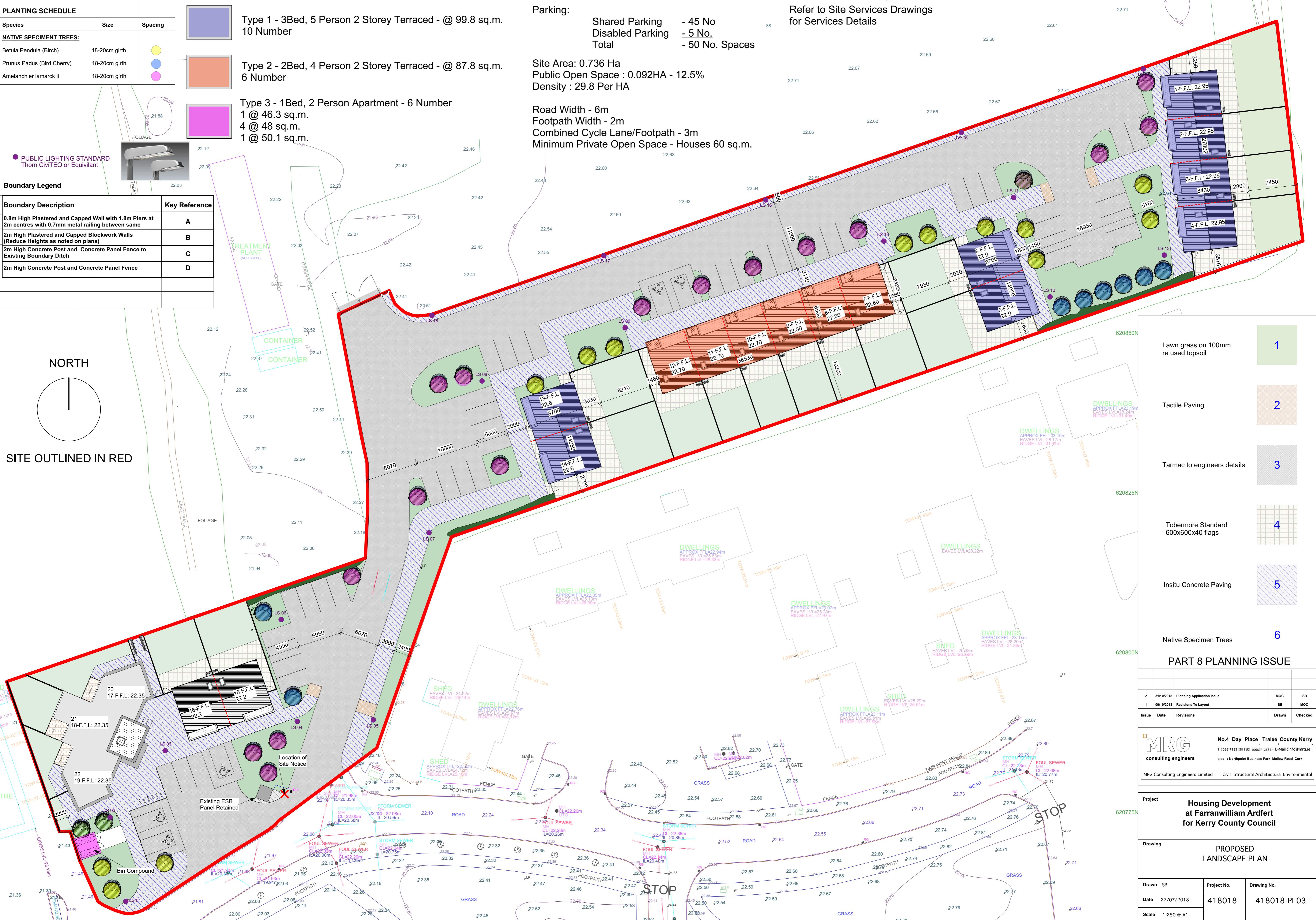
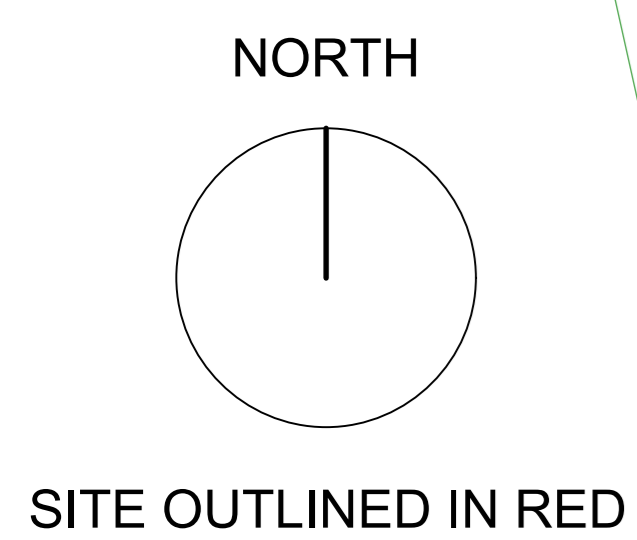

- Lawn grass on 100mm re used topsoil 1
- Tactile Paving 2
- Tarmac to engineers details 3
- Tobermore Standard 600x600x40 flags 4
- Insitu Concrete Paving 5
- Native Specimen Trees 6

**PART 8 PLANNING ISSUE**

Issue	Date	Revisions	Drawn	Checked
2	31/10/2018	Planning Application Issue	MOC	SB
1	09/10/2018	Revisions To Layout	SB	MOC

**MRG** No.4 Day Place Tralee County Kerry  
 consulting engineers  
 T 0667123130 Fax 10667123364 E-Mail: info@mr.ie  
 also : Northpoint Business Park, Malrow Road Co. Kerry  
 MRG Consulting Engineers Limited Civil Structural Architectural Environmental

**Project**  
**Housing Development at Farranwilliam Ardfert for Kerry County Council**

**Drawing**  
**PROPOSED LANDSCAPE PLAN**

Drawn	SB	Project No.	Drawing No.
Date	27/07/2018	418018	418018-PL03
Scale	1:250 @ A1		